

BRIGHT
WITH
LIGHT

↓ ANY CEILING ANY LIGHT

AT MULTILINE, WE AIM TO COLLABORATE ON PROJECTS THAT ARE NOT ONLY FUNCTIONAL BUT ALSO AESTHETIC AND INSPIRING

THIS IS MADE POSSIBLE BY OUR COMMITMENT TO MEETING HIGH STANDARDS, DRIVEN BY A SHARED VISION OF QUALITY AND INNOVATION. FROM AN ARCHITECTURAL PERSPECTIVE, A VISUALLY IMPRESSIVE CEILING LOSES ITS IMPACT IF THE LUMINAIRES FAIL TO COMPLEMENT THE DESIGN

THAT'S WHY WE DEVELOPED OUR REKTA PRODUCT LINE — *THE GO-TO SOLUTION FOR ANY CEILING*



- 06 **The perfect fit**
Light made for your space
- 12 **Less is more**
Seamless light, effortless brilliance
- 18 **Form, function & flair**
Lighting designed just for you
- 24 **Bright ideas**
Seamlessly integrated
- 30 **Interview**
Light follows function

INDEX

THE PERFECT FIT



↓
LIGHTING
IS KEY TO
COMFORT

DON'T TAKE IT
LIGHTLY

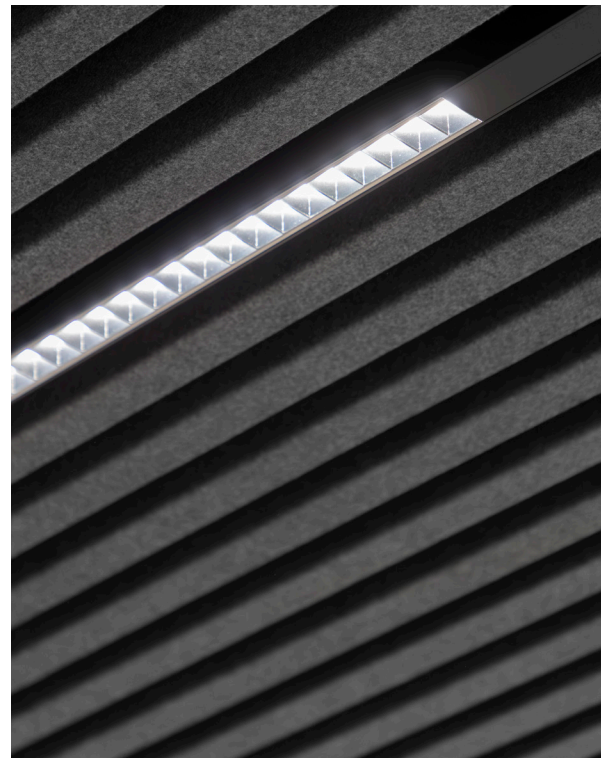

WHETHER YOUR GOAL IS TO
ENHANCE THERMAL, AESTHETIC,
OR ACOUSTIC COMFORT, OUR TAILORED
PRODUCTS SEAMLESSLY ALIGN
WITH YOUR VISION

FROM ACTIVE TO PASSIVE SOLUTIONS,
AND MATERIALS RANGING FROM WOOD,
FELT AND CONCRETE TO METAL



MULTILINE PROVIDES
CUSTOMIZED LIGHTING
SOLUTIONS FOR EVERY TYPE
OF SUSPENDED CEILING

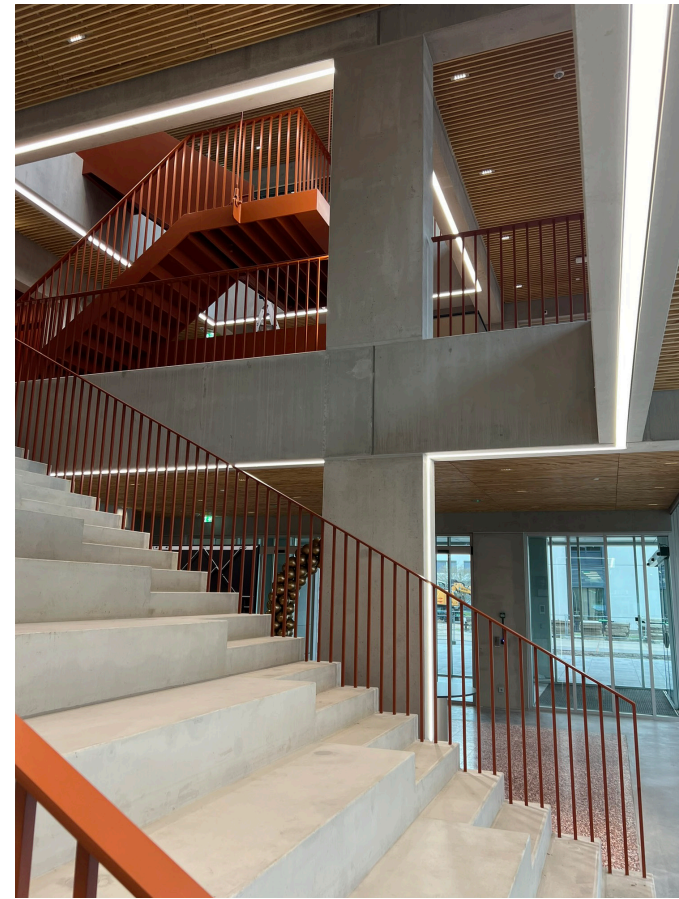

LESS

A KEY STRENGTH OF OUR LUMINAIRES
IS THEIR SEAMLESS INTEGRATION INTO THE CEILING,
EITHER AS A RECESSED, PENDANT OR SURFACE-
MOUNTED LUMINAIRE, ENHANCING THE SPACE
WITH SUBTLE YET *EFFECTIVE LIGHTING*

IS MORE



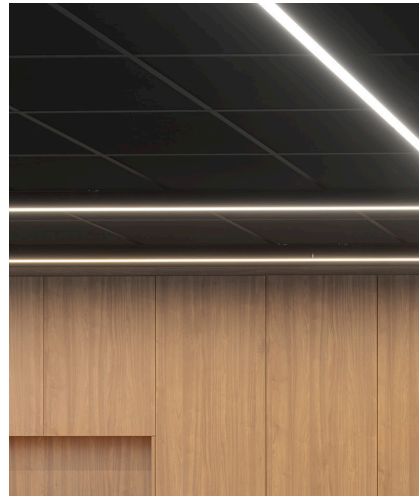
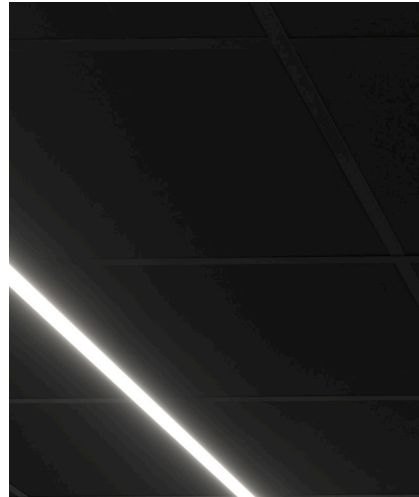
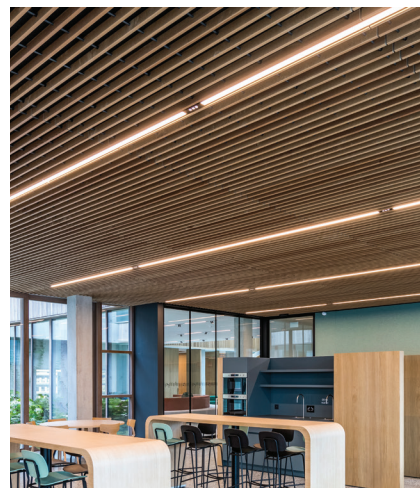

*THE MINIMALIST
DESIGN ENSURES
THAT THE FIXTURES
BLEND HARMONIOUSLY
WITH ARCHITECTURAL
ELEMENTS, ALLOWING
LIGHT TO TAKE CENTER
STAGE WITHOUT
VISUAL CLUTTER*

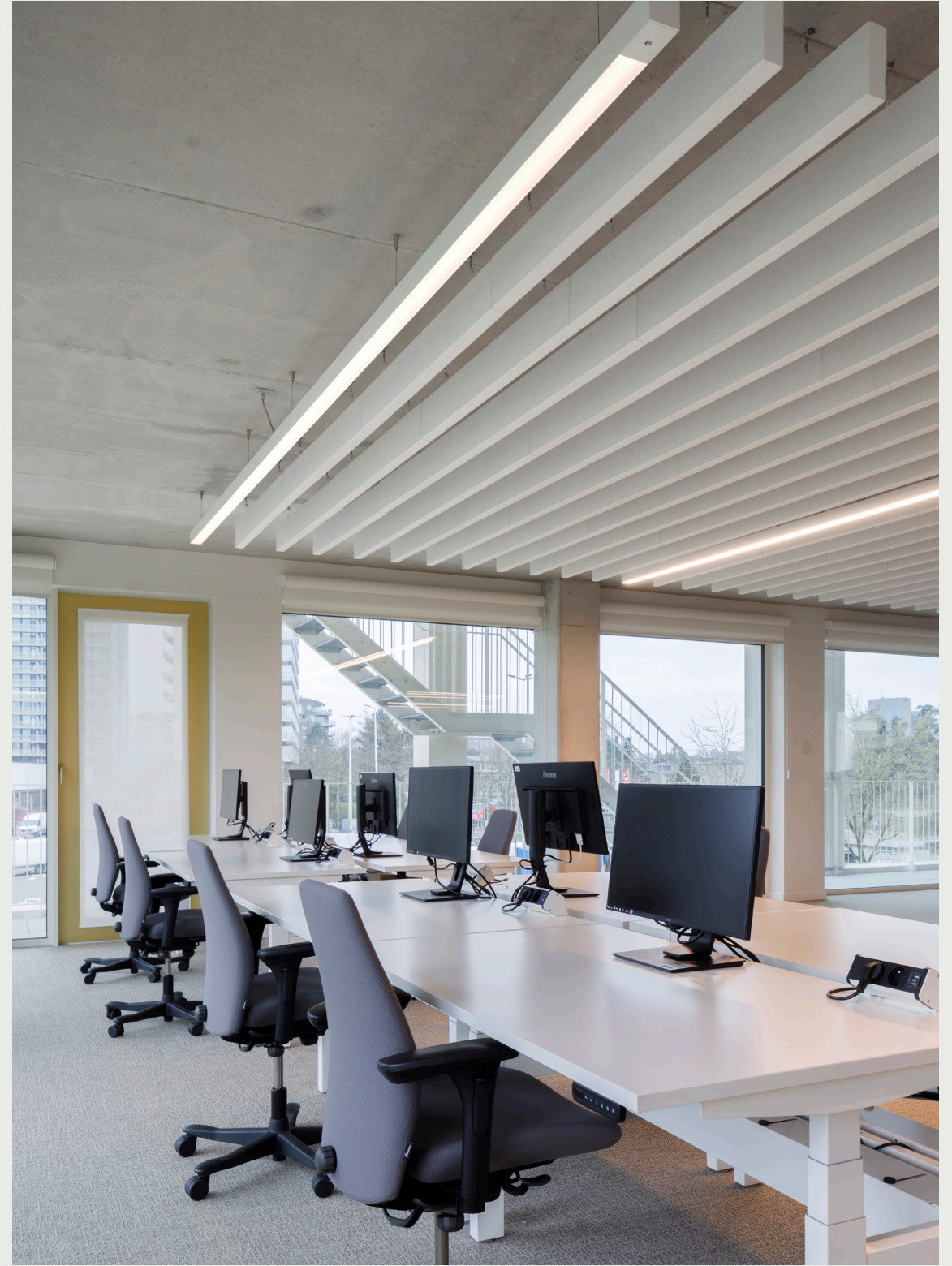

↓
ILLUMINATE
WITH
PRE
CISION

OUR SOLUTIONS CREATE REFINED
LIGHTING EFFECTS THAT COMPLEMENT
THE CEILING'S STRUCTURE WHILE MAINTAINING
A *CLEAN AND UNDERSTATED AESTHETIC*



FORM & FUNCTION FLAIR



FROM THE OUTSET, ACHIEVING THE RIGHT BALANCE BETWEEN AESTHETICS AND TECHNICAL PERFORMANCE IS KEY. AESTHETICS & LIGHTING COMFORT ARE ALWAYS AT THE HEART OF OUR APPROACH, *AND IT'S OUR MISSION TO BRING THESE TWO WORLDS TOGETHER*



BY INTEGRATING DIVERSE TECHNIQUES INTO OUR FIXTURES, WE ENSURE COMPLIANCE WITH PREDETERMINED STANDARDS SUCH AS AVERAGE ILLUMINANCE, UGR, AND OTHER CRITICAL PARAMETERS

AT THE SAME TIME, WE GIVE CUSTOMERS THE FREEDOM TO INSTALL LUMINAIRES SEAMLESSLY, REGARDLESS OF THE CEILING TYPE

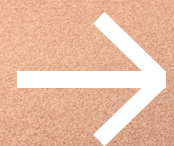

OUR ONGOING COMMITMENT TO OPTIMIZING
OUR PRODUCT RANGE ENSURES
MAXIMUM *FLEXIBILITY AND EASE OF USE*



BRIGH IDEAS

WE CREATE DESIGNS AND LUMINAIRES THAT SEAMLESSLY MEET THE REQUIREMENTS OF ANY SPACE. OUR GREATEST JOY COMES FROM SEEING OUR LUMINAIRES PERFECTLY INTEGRATED, ENHANCING A ROOM AND *DOING IT FULL JUSTICE*

↓ SEAM LESS DESIGN

OUR GOAL?
ACHIEVING
THE RIGHT
ATMOSPHERE



WHETHER IT'S LUMINAIRES THAT
ALIGN PERFECTLY WITH CEILING SLATS,
MATCH THE ROOM'S COLOR SCHEME,
OR FORM AN AESTHETICALLY
PLEASING ARRANGEMENT,
THE POSSIBILITIES ARE ENDLESS



THIS IS WHERE YOUR IMAGINATION
TRULY COMES TO LIFE

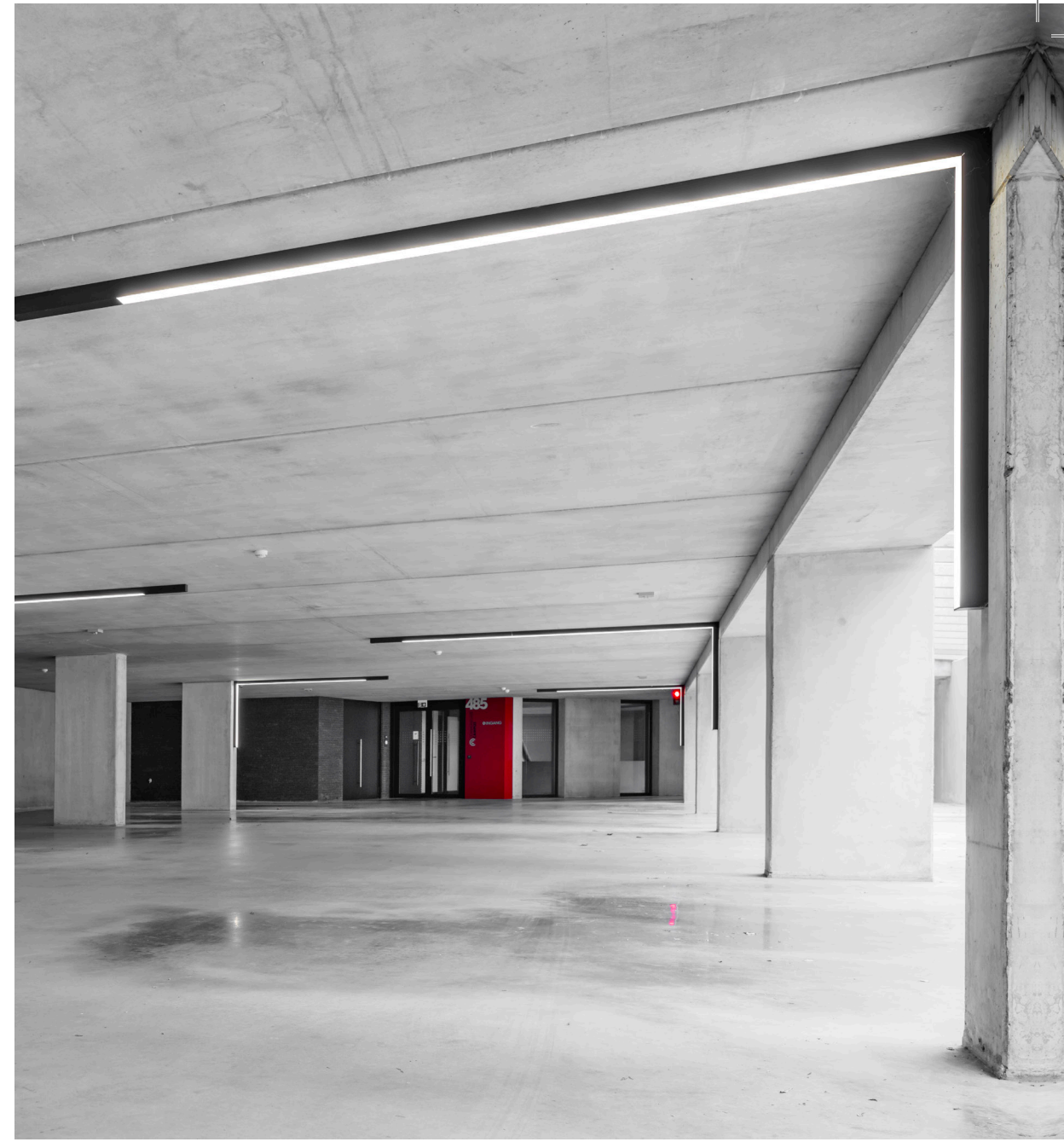



LIGHT FOLLOWS FUNCTION

Under the leadership of the family Rahne, Multiline has been an important player in the world of architectural lighting since 1982. Managing directors Monika and Klaus Rahne are now continuing the work their father started when he founded the company. Klaus reveals how they carry on his mission as a trendsetter in the world of architectural lighting.

"Multiline is known for its linear lighting solutions, with an extensive assortment of different models. To justify the term 'custom-made', we try to integrate as many different techniques and accessories as possible into the profiles, for example different types of diffusers, corner connections, loudspeakers, power rails, spots, uplighters and emergency lighting/emergency icons. We continue to innovate and update our lighting systems. The current range is extremely versatile and unlimited. On a technical level, we could meet almost any demand."

"Customized linear lighting and the development of luminaires in function of specific projects remain our speciality. Our lighting architects offer customers full support in terms of light plans and studies. From the very beginning, we think along with the client, the prescriber or the architect and provide advice in function of every specific space, while respecting the fundamental principle of light follows function."

AT MULTILINE WE ARE ALWAYS FINDING THE SOLUTION TO THE QUESTION OF WHICH LIGHT IS BEST IN FUNCTION OF THE USE

"Our goal is to keep innovating and to stay on top of market trends or even anticipate them. Energy efficiency, sustainability, circularity and smart lighting solutions are the keywords that will help determine the future of lighting. We also want to contribute to a healthy indoor climate in buildings where human-centric lighting is essential."

"Our strength lies in the knowhow, the available tools and the experience to develop new shapes and ideas as well as to integrate new techniques. We want to completely unburden our customers and fulfil a role that extends much further than that of a mere manufacturer. With our expertise in production, lighting advice and design, we are able to distinguish ourselves and continue to grow healthily as a durable company. As we have always done. Our new products and unique projects prove that our story is far from over."

GIVING
THE RIGHT
ADVICE IS
CRUCIAL



GIVING LIFE TO LIGHT

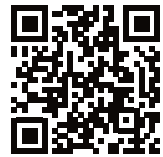

SCAN THE QR-CODE
AND DISCOVER
ALL SPECIFICS OF
*OUR LIGHTING
SOLUTIONS*

EUROPAWEG 1, B-3560 LUMMEN
+32 (0)11 450 260 | MULTILINE.BE



A photograph of a long, brightly lit concrete corridor. The floor is covered in a pattern of light and dark stripes. The walls are made of concrete, and the ceiling is also concrete. The corridor is illuminated by warm, yellow light from recessed fixtures. On the left side, there is a row of concrete columns. The corridor leads to an outdoor area with a grassy slope and a clear sky.

ILLU
MINATING

POSSI
BILITIES